

Radio Tubular Motor Specification



All control support 433MHz & 868MHz
All control support 230V/50Hz & 120V/60Hz

R Radio
Mechanic Limit + Built-in Receiver

By:
**35R, 45R, 45RM,
59R, 59RM, 45RQ**

Version No. A/00

T

Technical support

1. = x 5

One channel of emitter can control 20 receivers at most at the same time.

2. Radio Tubular Motor

One R motor maximum can store 20 channels, over 20 channels, it still need add new channel, it will cover NO.20th channel.

3. Control Range

4. Matchable emitter and motor



RED1-15 15-channel wireless emitter



RE02 Reusable portable wireless emitter

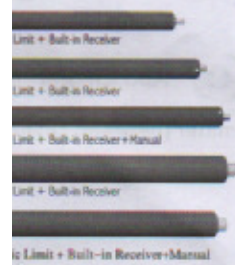

- In programming emitter and fit type motor, every time press it with upside and turn left and right as a signal (not press any seconds after the whistle, the motor will turn to original, at success of the set up, motor continuous whistle many times and right as signal.
- Receiver in the mode of dot function, press up key or down seconds, emitter control motor working in dot function, if count more than 2 seconds motor will stop working.
- Group control channel match code is unmatchable, while for motor, emitter + added and emitter - channel code unmatchable.

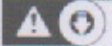

Attention:



Far away water



Technical support

ACCESSORIES ASSEMBLY

1. Fit the crown to the motor body enable crown can work with fixed key Assembly drive adapter, use clip to lock drive adapter and motor shaft.



Technical support

Wire Connection



Additional Function:

Programming the first emitter

The first method:



The second method:

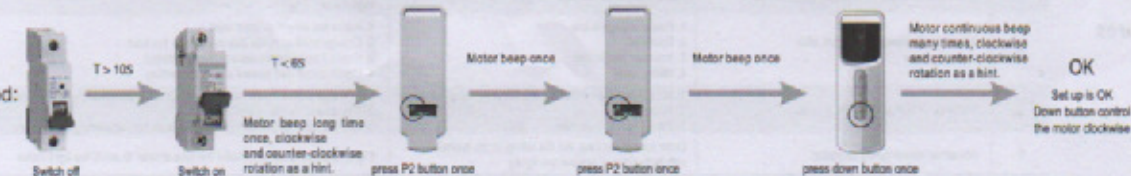

- The interval of each button must within 6 seconds of re-setting otherwise the system will restore the original state.
- Delete all the codes of motor when the new emitter has been programmed.

JOLA
KÍVÜL | BELÜL OTTHON

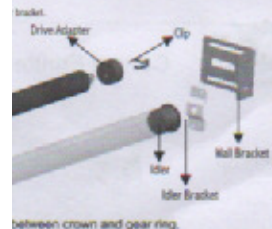

between crown and gear ring.

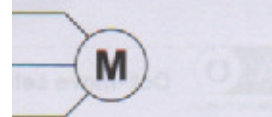

between crown and gear ring.

Common failure and solutions

Radio Tubular Motor Specification

Set The Limitation

Up and down limitation position this is where the roller blinds stop automatically.

⚠ When motor doesn't work, stop rotating red or white worm with regulator.

Up Position Set Up (White Screw Adjust Upward Limitation Position):

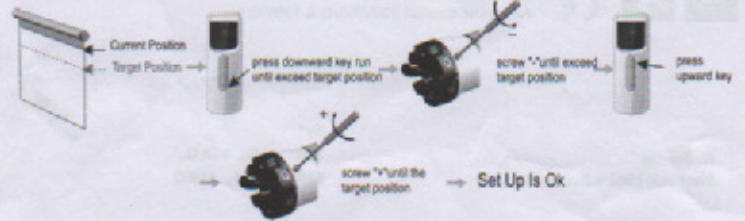
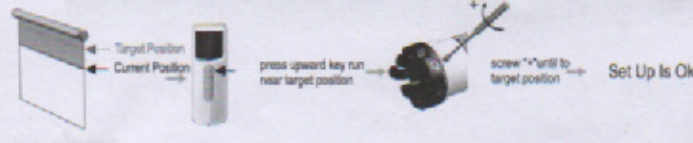

Down Position Set Up (Red Screw Adjust Downward Limitation Position):

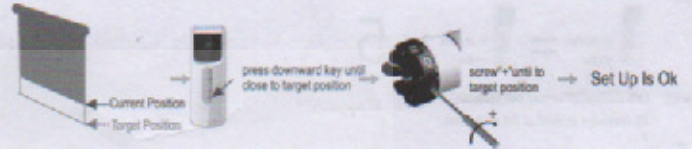
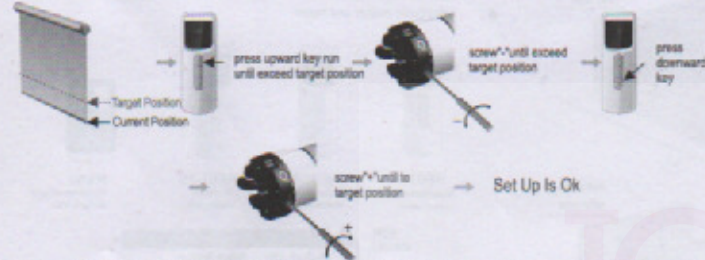

A Add Emitter

Additional Function:

Add emitter (between several emitters)

⚠ The interval of each button must within 6 seconds of re-setting otherwise the system will restore the original state.

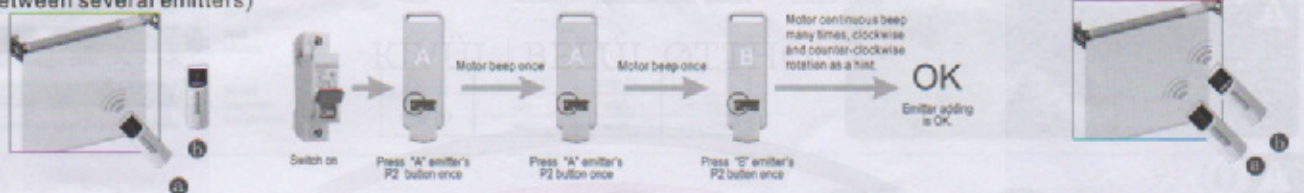

Add emitter channel (one multi-channel emitter)



A Cancel Emitter

Additional Function:

⚠ The interval of each button must within 6 seconds of re-setting otherwise the system will restore the original state. Cancelling emitter is that remove all the emitter memory of the motor.

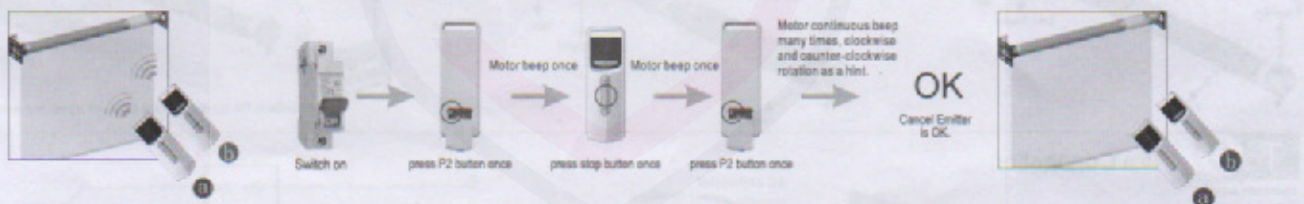

A Dot-move setting

Additional Function:

⚠ The interval of each button must within 6 seconds of re-setting otherwise the system will restore the original state. Repeat this setting, the dot-move function is cancelled.

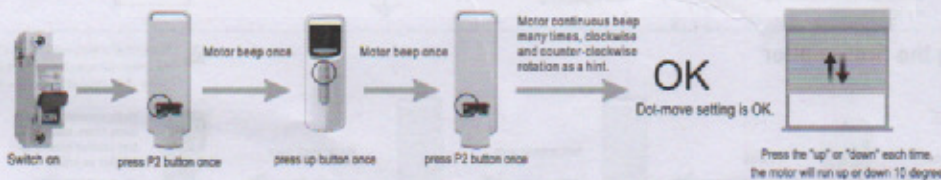

Attention:

Common failures and solutions

Fail-phenomena	Failure causes	Solutions failure recovery
1 Press up button, roller blinds run down	Programming direction is wrong	Use another way to reset up
2 When on, the motor runs in one-way operation	Inside limit switch of motor doesn't open	Crown running one circle in the opposite direction of the motor, then it's ok
3 Motor starts slowly or not work after connect power	1. Power voltage is low 2. Overload 3. Improper installation 4. Wiring error	1. Adjust the power to rated data 2. Change another motor that match with the load 3. Check if accessories were properly installed 4. Check circuit and correct wiring connecting
4 Motor stops suddenly during running	1. Motor has entered into a state of overheating protection 2. Power cut 3. Enter into the limit point	1. After about 20 minutes motor automatic recovery to normal working condition 2. After power on can restartable 3. Whether you need to adjust limit screw or not, depending on the state
5 Abnormal sound during operation	Outer tube is too long, led the rolling blinds connects with both sides of bracket too slightly	If idler is active, properly make the tube shorter to avoid too tight status